

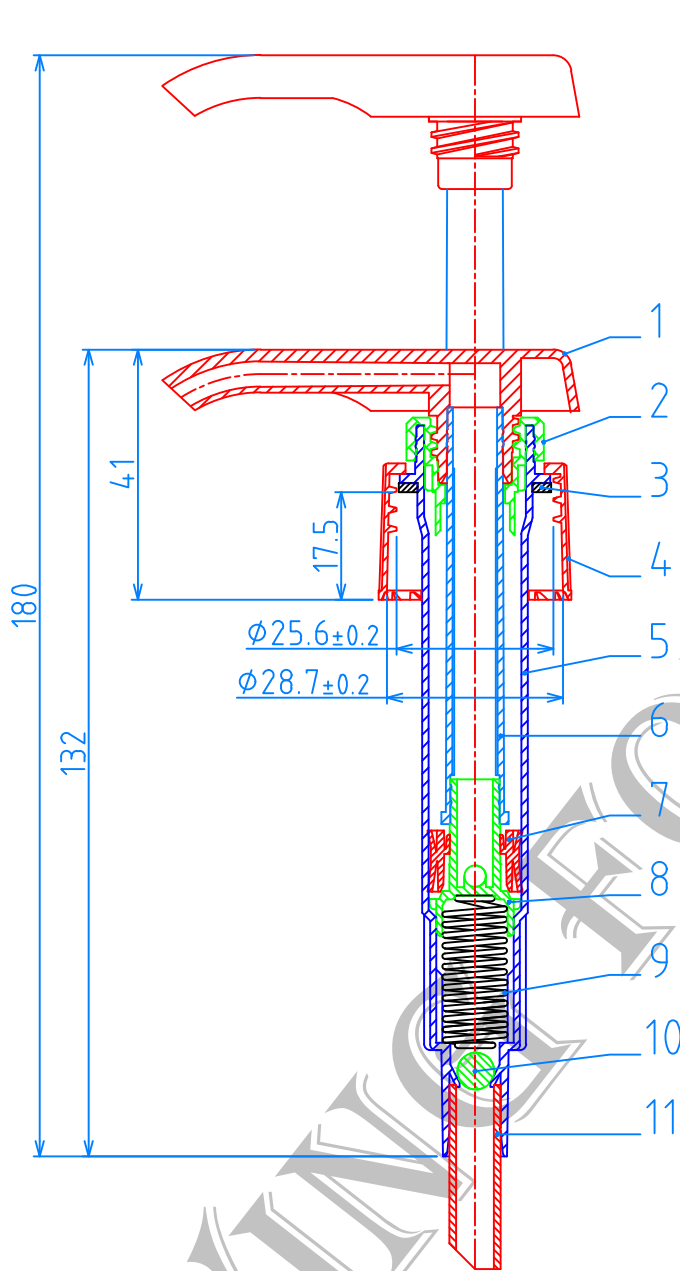

8.0cc Dispenser Pump(DP-802)

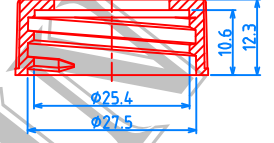

(28/400) CAP, P=1"x6 TPI



(28/400) CAP, P=1"x8 TPI

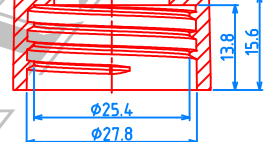

(28/410) CAP, P=1"x6 TPI

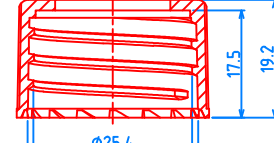

(38/400) CAP, P=1"x6 TPI (高)

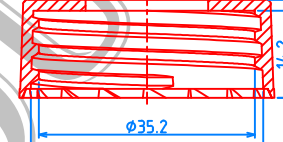

(28/415) CAP, P=1"x6 TPI

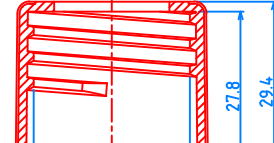

(28/強壓式) CAP

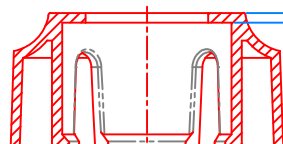

(28/水胚) CAP, P=1"x8 TPI

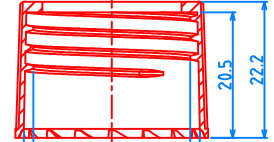

(38/400) CAP, P=1"x6 TPI (中)

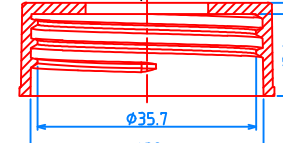

(30/400) CAP, P=1"x8 TPI

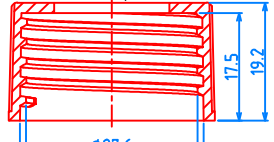

(38/400) CAP, P=1"x6 TPI (低)

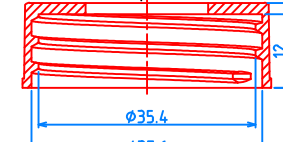

(33/410) CAP, P=1"x6 TPI

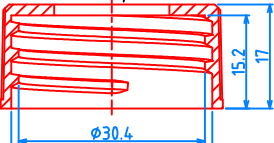

(38/410) CAP, P=1"x6 TPI

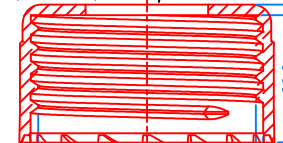

Item	Description	Material
1	按頭 ACTUATOR	PP
2	結合蓋 CHAPLET	PP
3	墊片 GASKET	LDPE
4	(28/水胚)牙蓋 CAP	PP
5	缸體 HOUSING	PP
6	活塞桿 PLUNGER	PP
7	活塞環 PISTON RING	LDPE
8	活塞座 PISTON BASE	HDPE
9	彈簧 SPRING	SUS-304
10	塑膠珠 PLASTIC BALL	ABS
11	吸管 (20cm) TUBE	LDPE

Date 2018/04/12
Drawing No. dp802-a1-28001